

## SMD SPDT Switch



### RF SPEC.

Frequency Range	DC-1GHZ	1-2GHZ	2-3GHZ	*3-6GHZ	*6-12GHZ	*12-18GHZ
VSWR	<1.10	<1.15	<1.20	1.50	1.70	1.90
Insertion Loss	<0.1dB	<0.2dB	<0.3dB	<0.5dB	<0.70dB	<0.9dB
Isolation	>70dB	>65dB	>60dB	>55dB	>50dB	>45dB
Power Handling(CW)	50W	30W	20W	10W	8W	5W

\*Option: Frequency Range: DC-3GHZ; DC-6GHZ; DC-12GHZ, DC-18GHZ

- . Impedance: 50 ohm
- . Failsafe Type
- . Operating Voltage: DC12V / 120mA (Option DC28V)
- . Switching Time: <10ms
- . Life: >100,000 cycles
- . Operating Temperature: -40 ~ +85°C
- . Size: 16X16X10mm(LXWLH)
- . P/N SPEC.

**1SD21203** –SMD/SPDT/DC12V/DC-3GHZ ; **1SD21206** –SMD/SPDT/DC12V/DC-6GHZ

SIZE:

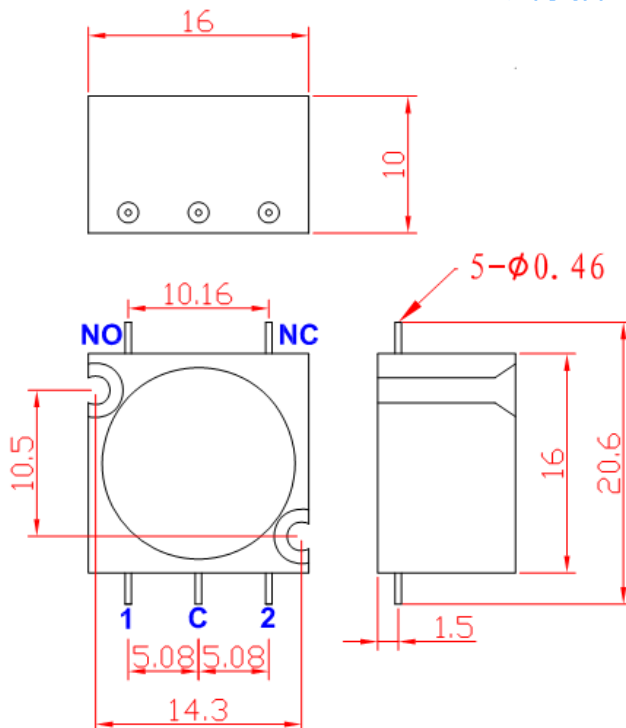

\* Pin1,2 Connected with DC12V

\* Fixed with DIN 965 M2X12 screws



Tel :0086-10-82087227

Fax:0086-10-82087380

E-mail: rfswitch@126.com

Web site: www.rf-switch.com